

Please take the time to read this quick installation guide. The guide contains important information and notes regarding the installation and operation of Sedna® Wallwasher Series

WARNING: This product must be installed in accordance with the applicable installation code by a competent persons familiar with the installation and operation of the product, IEEE national wiring standards & hazards involved

Installation Instructions

DANGER-RISK OF SHOCK-DISCONNECT POWER BEFORE INSTALLATION - DO NOT TOUCH LED EXPOSED COMPONENTS/PCB

- Identify installation location & check for any passing wiring/piping prior drilling and installing cables.
Note: Ensure chosen surface is of sufficient strength/thickness to withstand weight of the luminaire. Refer to manufacturers specification sheet for further information on windage and weights.
- Using the allen key bolts, remove mounting feet. Using a suitable strength screw/bolt, fix mounting feet into position. Then with allen key, align to the luminaire, re-connect allen key bolts & angle to the desired position. Tighten bolts accordingly to lock into position.
- LED Wall Washers can be used in several ways depending on the type in the series that you have:

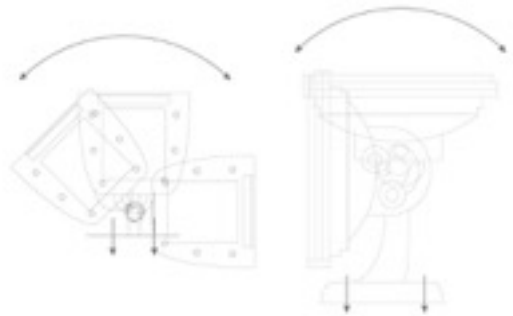

Single Colour without a on-board controller(stand-alone):

One or more wall washers are used independently without on-board colour or functionality controls. Connect 100-280V AC via power input.

With on-board controls:

- Individual Addressing: One or more wall washers are used independently with on-board colour controls; modes include fading, flashing, static colours and seven colours changing in sequence.
- Master/Slave: Multiple wall washers are daisy-chained via XLR-3 looping in/out connectors and synchronised to the first (master) wall washer in the series (**10 fixture limit**).

ADDRESSING INSTRUCTIONS: STAND-ALONE (One or more wall washers used with on-board colour controls, without a DMX Controller)

XLR-3 DMX SIGNAL INTERFACE

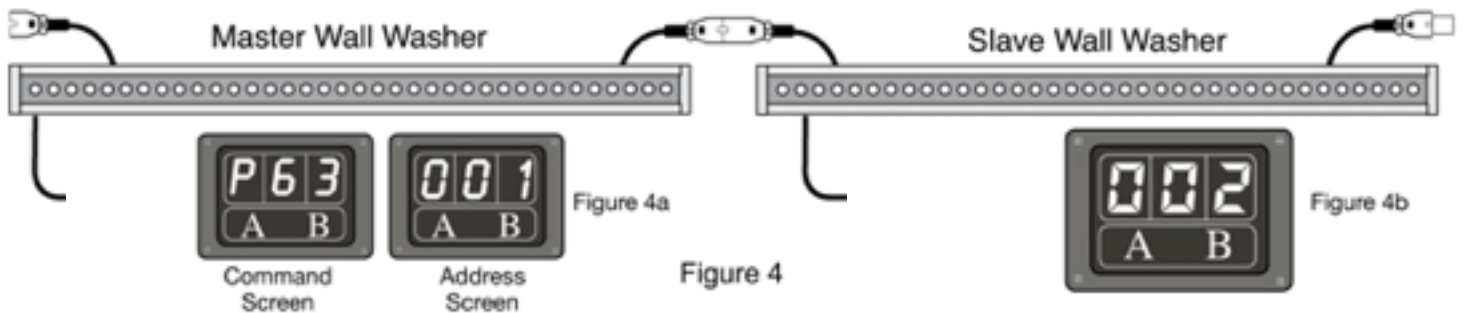
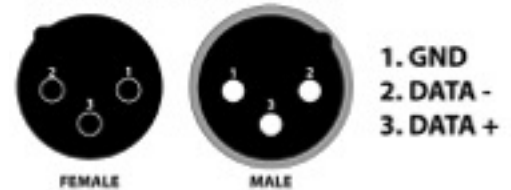

- Program a single washer or the first in a series: Use selection buttons (Figure 3) to set colour mode, speed and brightness level. A wall washer in stand-alone mode will only be adjusted in the Command Menu. Number field 1 is occupied by "P", number field 2 sets the static colour or colour-changing mode, and number field 3 sets brightness level (if in static colour mode) or speed (if in colour-changing mode). For example, a static Cyan colour with a brightness level of 3 would be set using button A to select number field 2, and button B to select "6"; then use button A to select number field 3, and button B to select "3".
- Daisy-chain multiple wall washers (if applicable): connect the output XLR-3 cable of the first wall washer to a XLR-3 cable of the next wall washer in the series.

3. After setting Master command menu to "P63", set the address of the Master to 001 (Figure 4a) and all subsequent washers to 002 to synchronise them (Figure 4b).

**Figure 2
Interface Overview:**

Button "A" cycles through number fields.
Button "B" selects a value of 0-9.

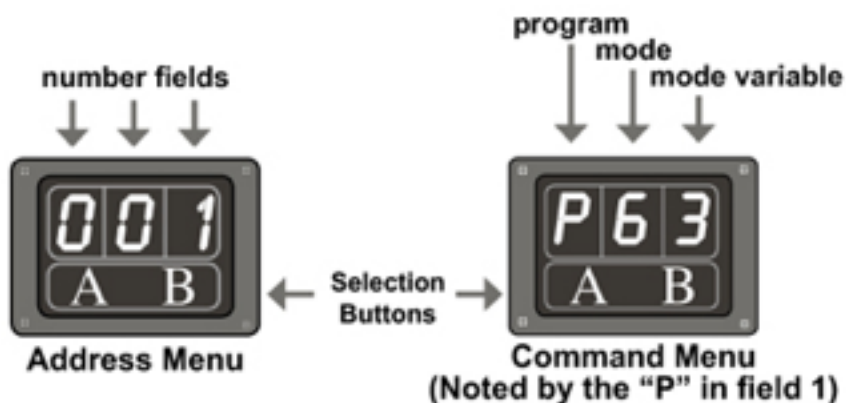

Number field 1	Number field 2	Number field 3
P	1- Static Red	1-9 Brightness Control
P	2- Static Green	1-9 Brightness Control
P	3- Static Yellow	1-9 Brightness Control
P	4- Static Blue	1-9 Brightness Control
P	5- Static Purple	1-9 Brightness Control
P	6- Static Cyan	1-9 Brightness Control
P	7- Static White	1-9 Brightness Control
P	8- Primary Color Fade	1-9 Speed Control
P	9- Secondary Color Fade	1-9 Speed Control
P	A- Random-Color Fade	1-9 Speed Control
P	B- Random-Color Flashing	1-9 Speed Control
P	C- Cycle All Modes	1-9 Speed Control

A wall washer used in stand-alone mode will always be set to "P" in number field 1. Number field 2 sets the static colour or colour-changing mode. Number field 3 sets brightness level (if in static colour mode) or speed (if in colour-changing mode).

With an external DMX Controller:

- Individual Addressing: Multiple wall washers are daisy-chained with each individually addressed to respond to individual channels on a DMX controller (capability depends on your controller).
- Master/Slave: Multiple wall washers are daisy-chained and synchronised to an external DMX colour controller (**10 fixture limit**).

ADDRESSING INSTRUCTIONS: DMX CONTROLLER (one or more wall washers commanded by a DMX controller)

1. Connect the single or primary wall washer to a DMX Controller using one of the fixture's XLR-3 cables taking note of the D +/D- signal entry.
2. Daisy-chain multiple wall washers (if applicable) via XLR-3 looping in/out connectors of the next wall washer in the series.
3. To individually address: On each wall washer, set the address to equal the number of the channel on the DMX Controller. For example, channel 001 on the DMX Controller would be addressed by using button A to select number field 1, then button B to select "0"; then using button A to select number field 2, and button B to select "0"; then using button A to select number field 3, and button B to select "1" (Figure 5).
4. Once addressed, each wall washer will respond to the DMX Controller according to the channel selected on the DMX Controller.
5. Note: DMX colour controllers vary in function. Review the manufacturers colour controller instructions for optimum use.

Figure 5

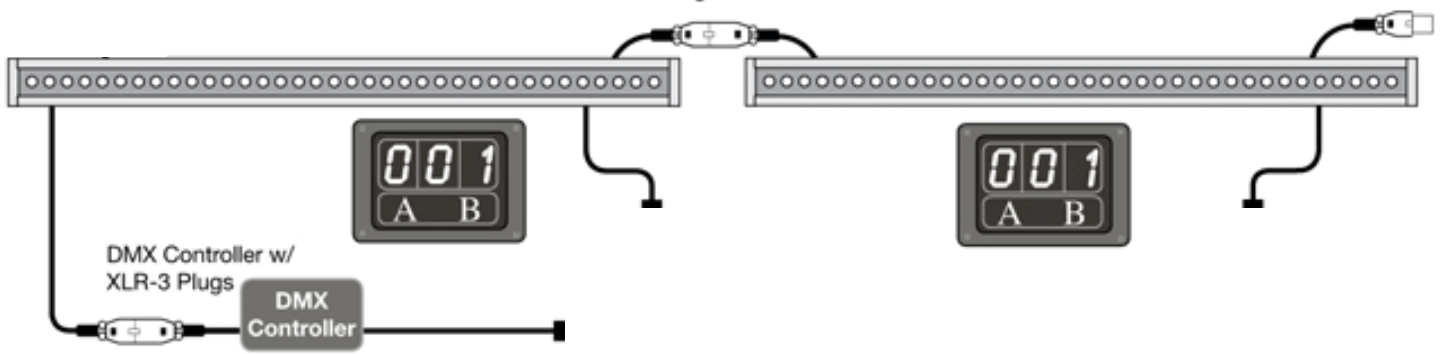

4. Once satisfied with your configuration is set up correctly and you have checked all the connections, its important that if your installation is in a wet environment or outdoors, that all connections made via the XLR-3 connectors are sealed & waterproofed using the heat-shrink tubes. Use a heat gun with a minimum heat temperature of 100°C for the included shrink tube.

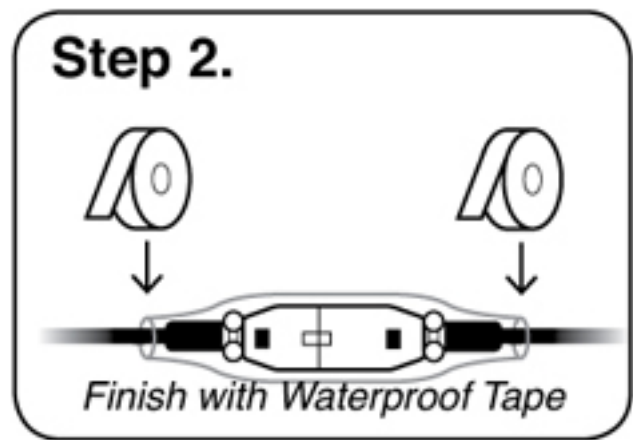
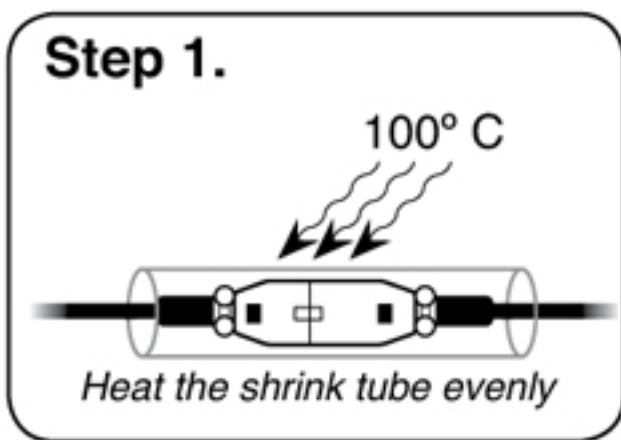

5. Repeat steps 1 to 4 for each additional luminaires.
6. Connect 100-280V AC via power input ensuring to maintain the correct protection against liquid if installation is in a wet environment or outdoors.
7. Check all connections are sound and properly insulated. Verify that the modifications are correct and safe.
8. Switch power on and test.

NOTE: Installation of LED luminaire with modification to the unit, or incorrect fitting in accordance with the above instructions could result in damage/failure of the luminaire, which may invalidate warranty.

WARNINGS, CAUTIONS AND OPERATING INSTRUCTIONS

1. Risk of fire or electric shock. The electrical rating of these products are 100 - 280V AC, the installer must determine whether they have 100 - 280V AC at the luminaire before installation.
2. Risk of fire or electric shock. Luminaires wiring, or other electrical parts may be damaged when installing of other hardware. Check for enclosed wiring and components.
3. Risk of fire or electric shock. Kit installation requires knowledge national wiring and electrical systems. If not qualified, do not attempt installation. Contact a qualified electrician.
4. To prevent wiring damage or abrasion, do not expose wiring to edges of sheet metal or other sharp objects.
5. Do not make or alter any open holes in an enclosure of wiring or electrical components during kit installation.

WARNING - Risk of fire or electric shock. Install this kit only in the luminaires that have the construction features and dimensions shown in the photographs and/or drawings.

For more information, contact your supplier for further details. Installers should remove any existing wire/luminaire systems prior to installation.

THIS DEVICE IS NOT INTENDED FOR USE WITH EMERGENCY EXITS.

Luminaire must be operated within an ambient fixture temperature of -20°C to 50°C to comply with all safety and warranty regulations. Ensure sufficient air flow around the for efficient heat dissipation. Failure to do so could significantly reduce luminaire life and/or safety/warranty regulations.

Environmental Protection (W.E.E.E.) – Waste Electrical & Electronic Equipment Regulations (WEEE) requires that any of our products showing this marking (left) must not be disposed of with other household or commercial waste. We do not levy any WEEE disposal charges to its customers for affected WEEE related products. To prevent possible harm to the environment or human health from uncontrolled waste disposal, please separate any such product from other waste types and recycle it responsibly at your local facilities. Check with your Local Authority, Recycling Centre or retailer for recycling advice. If, when you purchased product, your supplier included a WEEE disposal fee, you should then contact your supplier for advice on their take-back of the product for the correct disposal.

MANUFACTURER'S GUARANTEE - This product is guaranteed in the country of purchase for the number of years as stated from the date of purchase. The guarantee is invalid in the case of improper use, installation, tampering, removal of the Q.C. date label, installation in an improper working environment or installation not in accordance with the advised instructions and/or national wiring regulations. Should this product fail during the guarantee period it will be replaced free of charge, subject to correct installation and return of the faulty unit. We not accept responsibility for any installation costs associated with the replacement of this product. This warranty is in addition to the statutory rights in your country of purchase and reserve the right to alter specifications without prior notice.